

The product contains one or more of following materials:
Metal, plastic, wood, fabric, foam.

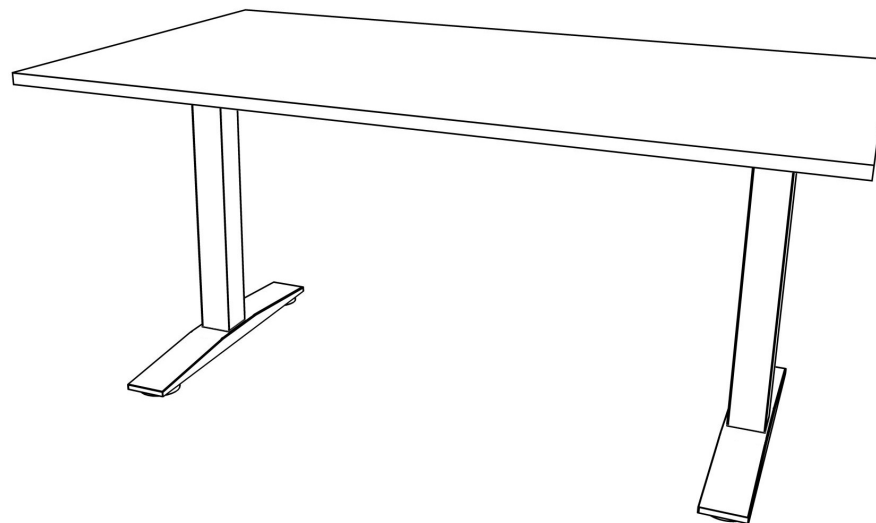

EFG Rise - Parts

Overview of all parts for the frame (excluding cables, control box and cables).

Code	Picture	Qty	Spec	Remark
a		2		
b		2		
c		2		
d		2		
e		2		
f		2		
g		20	M6x15	
h		8	M10x25	
i		4		
j		1		
k		12	M6x20	screws for table top
l		6	M3.5x16	screws for a cable clip
m		2	M5x15	screws for control box
n		2	M3x30	screws for handset
o		6		R-cable clips
p		24		guide sleeves
q		2		wire clips

EFG Rise - Frame assembly (overview)

Position of parts and how to install the frame.

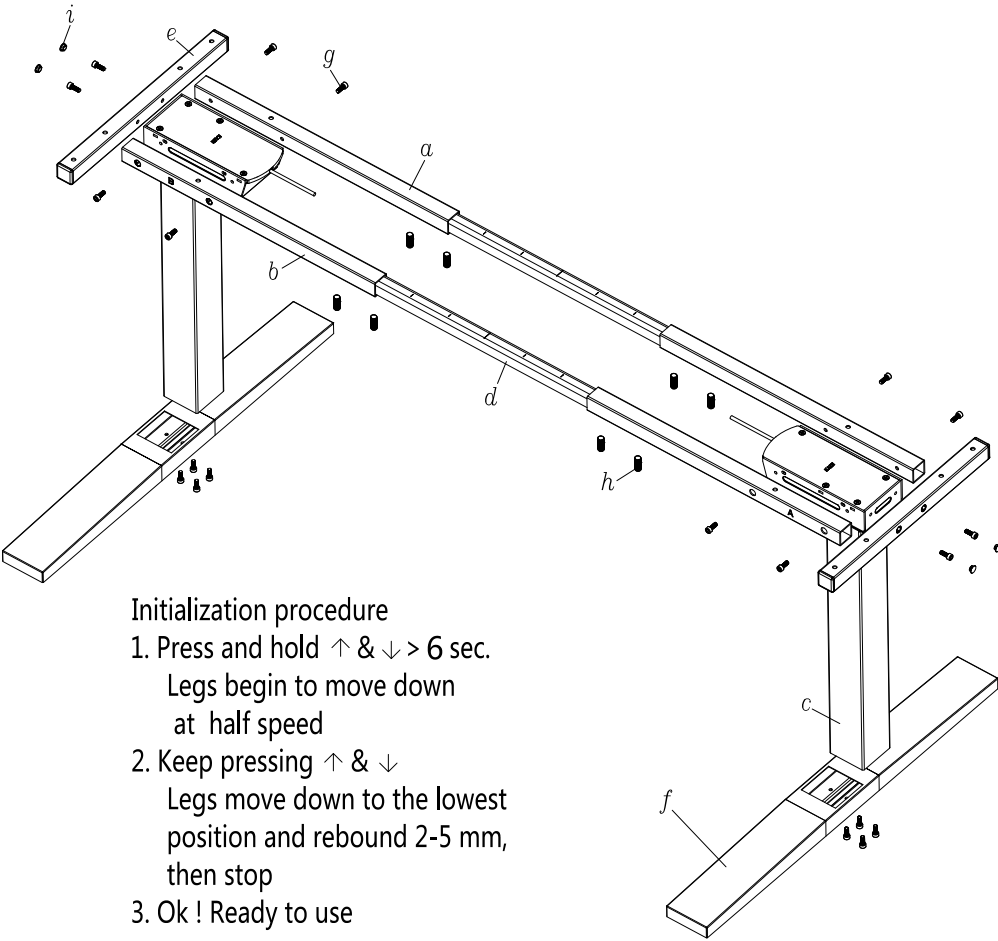

Initialization procedure

1. Press and hold \uparrow & \downarrow > 6 sec.
Legs begin to move down
at half speed
2. Keep pressing \uparrow & \downarrow
Legs move down to the lowest
position and rebound 2-5 mm,
then stop
3. Ok ! Ready to use

EFG Rise - Frame assembly - Step 1

Step 1 = Mount feet **F** to legs **C**. Use screws **G** and Tool **J**.

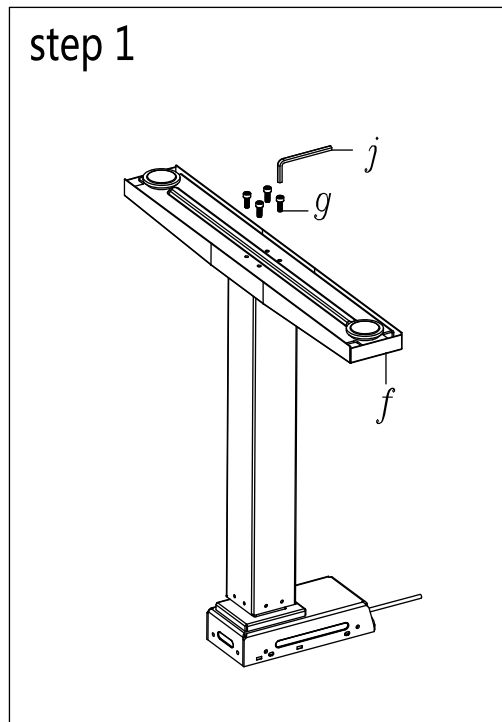

EFG Rise - Frame assembly - Step 2 & 3

Step 2 = Mount beams **A** and **B** to leg, place the beams smaller holes towards top of frame. Use screws **G** and Tool **J**. Use guide sleeves **P** for easier mounting.

Mount Side support **E** with smaller holes towards the top of frame. Use screw **G** and Tool **J**. Use guide sleeves **P** for easier mounting.

Step 3 = Same as Step 2, but switch place on beams **A** and **B**.

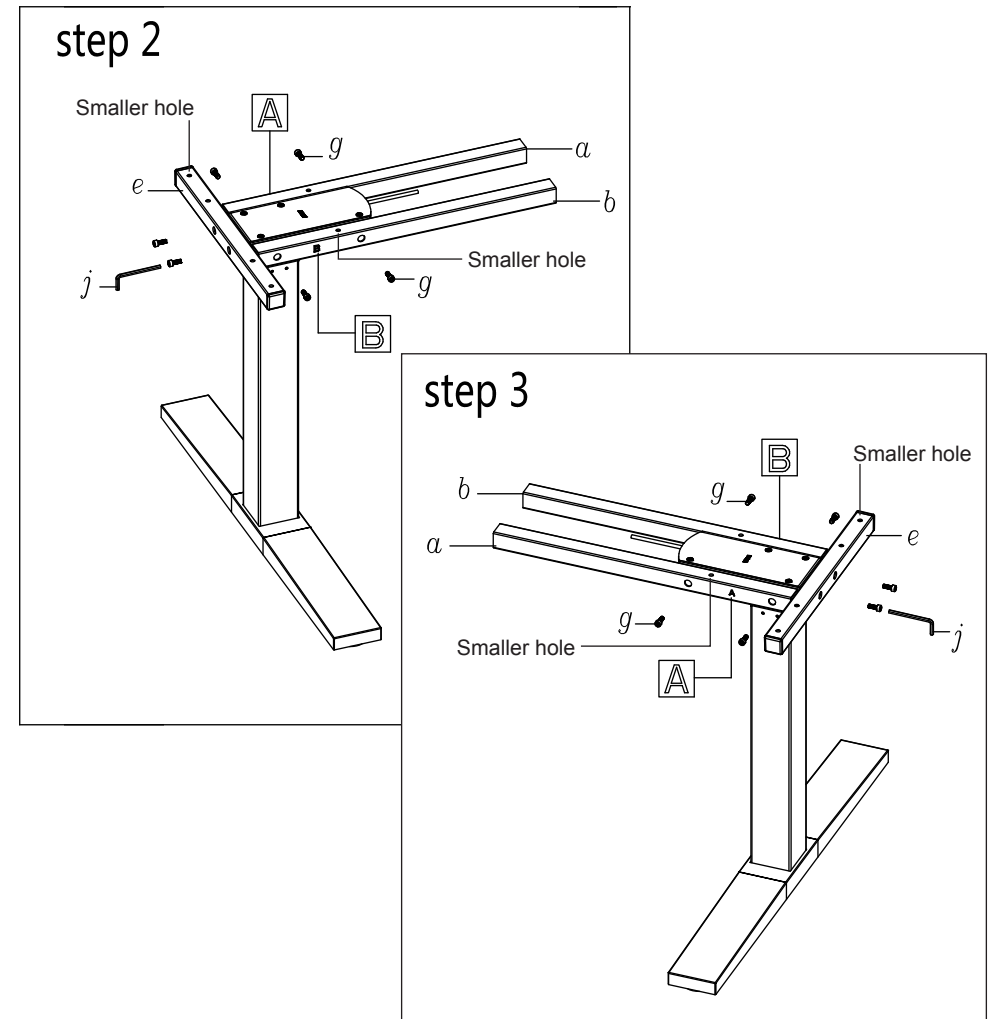

EFG Rise - Frame assembly - Step 4 & 5

- Step 4 = Assemble U-profiles **D** inside the beams **A** and **B**.
Place bottom of the profile (pattern) towards the top of frame.
Adjust the length of frame and lock it with screws **H** and tool **J**.
Step 5 = Mount end caps **I** on side supports gable holes (**E**).

step 4

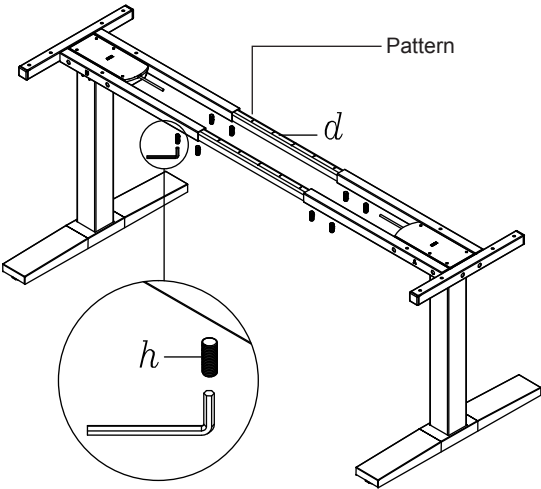

step 5

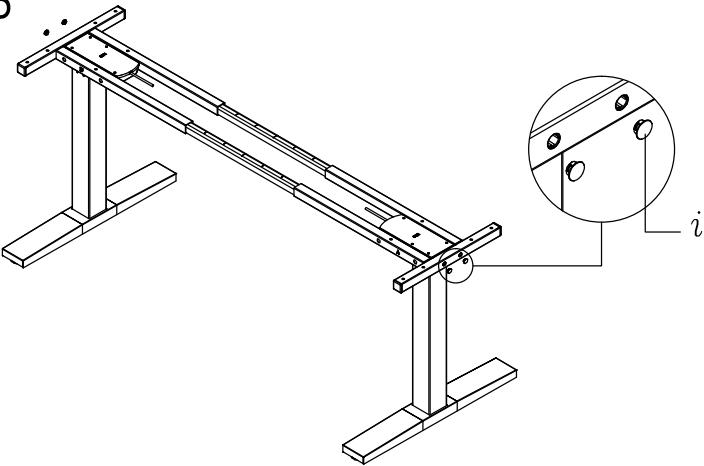

EFG Rise - Frame assembly - Step 6, 7, 8 & 9

- Step 6 = Place frame on table top and assemble it with screw **K** in holes on beams **A** and **B**, plus side supports **E**. Use guide sleeves **P** for easier mounting.
Step 7 = Mount handset with screws **N** and control box with screws **M**.
Step 8 = Use cable clips **O** and screws **L** to mount the cable of the handset and the remaining cables of the frame. Add wire clips **Q** to collect cables and make it neat.
Step 9 = Observe and finish!
Go through the initialization procedure (page 3).

OBSERVE:
Make sure every screw is tightened before use.
Turn the table around to standing position and plug the cable.
Ready to use!

<i>k</i>		12	M6x20	screws for table top
<i>l</i>		6	M3.5x16	screws for a cable clip
<i>m</i>		2	M5x15	screws for control box
<i>n</i>		2	M3x30	screws for handset
<i>o</i>		6		R-cable clips
<i>p</i>		24		guide sleeves
<i>q</i>		2		wire clips